

Moses Everet

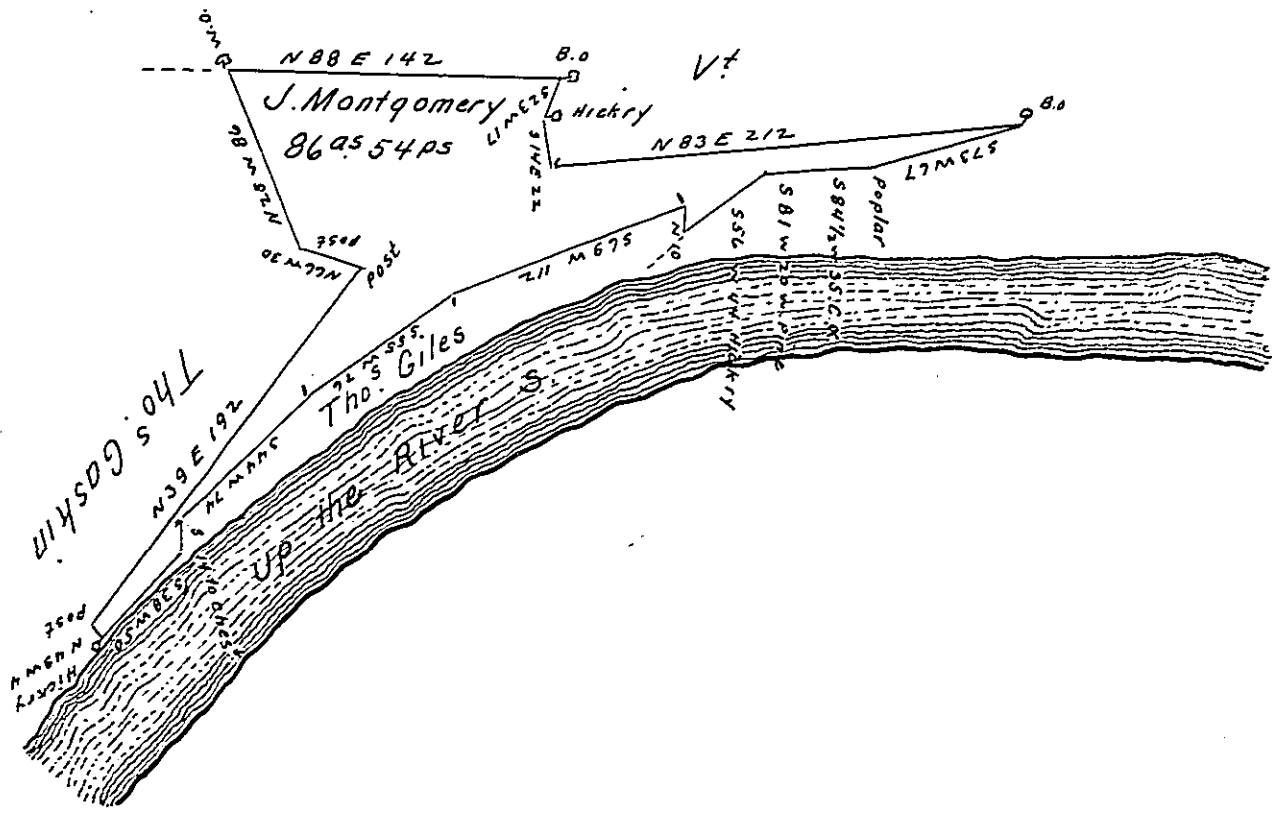

By Virtue of a Warr^t dated Dec^r 23^d 1793. Surveyed to John Montgomery the 16th day of December 1795 the above described Tract of Eighty Six Acres and 54 perches of Land and the Usual All^s. Situated adjoining on the River below Tho^s Giles and extending Northeastward and adjoining him chiefly in Mahoning Town^p. North^{bd} County.

By W^m Montgomery D.S.^r

To Daniel Brodhead Esq^r.
 Surv^r Gen^l of Pensylv^a

IN TESTIMONY that the above is a copy of the original remaining on file in the Department of Internal Affairs of Pennsylvania, made conformably to an Act of Assembly approved the 16th day of February, 1833, I have hereunto set my Hand and caused the Seal of said Department to be affixed at Harrisburg, this tenth day of November 1905.

Samuel P. ...
 Secretary of Internal Affairs.